

BNC
AUTOCONTROL

FLOWMETER

ROTORS FLOW METER

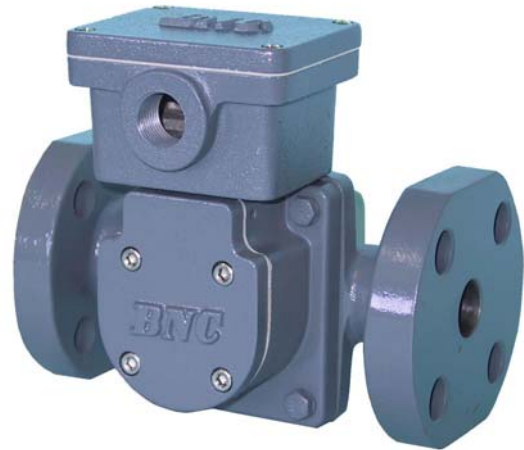

BNC industrial co., ltd.

GENERAL SPECIFICATION

FEATURES

- High Accuracy $\pm 0.5\%$
- High Temp. and pressure up to 150°C, 20kg
- High, Low speed pulse signal output
- Low cost Long Life

BASIC METER

Nominal Size	15 , 20 mm	
Accuracy	within $\pm 0.5\%$	
Max. operating pressure	10kg , 20kg	
Max. operating temperature	80°C, 120°C , 150°C	
Flange rating	ASA 150LB or JIS 10kgf/cm ² ,20kgf/cm ² ,16kgf/cm ² , BSP(F) ports	
Material	Meter body	FC 25 , SUS 316
	Rotors	Resin (PPS)
	Register Housing	Aluminium alloy
Display	Totalizing Counter	8-digit LCD
	Reset Counter	5-digit LCD
Power	Lithium battery	Ratings : 3.6V Life : Approx, 3 or 6 years
Output	Pulse	Max. switching 50V DC, 50mA DC(Reed Switch)

FLOW RANGE

Unit: mm

Model	Size	Flow Range (L/H)	L-A	L-B	L-C	H	W
BH 15 S	15	5 ~ 200	114				130
BH 15	15	10 ~ 700	114	140	170	235	130
BH 20	20	20 ~ 1300	165	203	170	235	130

MODEL CODE

Basic Model	Size	Max. Temp.	Mat'l	Display/output	Connection	Description	
BH	15 S					1/2" (15 mm)	
						1/2" (15mm)	
						3/4" (20mm)	
		-0					120 °C
							150 °C
				F			Body / FC 25 , Rotors / PPS
							S
					1		5 digit Flowrate/8 digit Totalizer
					2		Totalizer 8 digit/Reset 5 Digit
					3		Pulse output only
				4		5 digit Flowrate/8 digit Totalizer/Pulse	
				5		5 digit Flowrate/8 digit Totalizer/4-20 mA	
				+ 6		Explosion Proof-Class I, Division I, Groups B,C&D	
				7			
					BSP	BSP Thread	
					J10	JIS 10K FF	
					J20	JIS 20K FF	
					A15	ANSI 150#FF	
					A30	ANSI 300#FF	
					P10	PN 10	
					P16	PN 16	
					P20	PN 20	

L-B : ANSI Flange
L-C : JIS Flange
L-A : BSP Thread

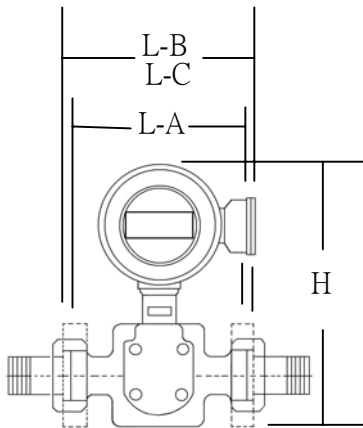

BNC
AUTOCONTROL

FLOWMETER

ROTORS FLOW METER



BNC industrial co., ltd.

GENERAL SPECIFICATION

FEATURES

- High Accuracy $\pm 0.5\%$
- High Temp. and pressure up to 150°C, 20kg
- High. Low speed pulse signal output
- Low cost Long Life

BASIC METER

Nominal Size	25 , 40 mm	
Accuracy	within $\pm 0.5\%$	
Max. operating pressure	10kg , 20kg	
Max. operating temperature	80°C, 120°C , 150°C	
Flange rating	ASA 150LB or JIS 10kgf/cm ² ,20kgf/cm ² ,16kgf/cm ² , BSP(F) ports	
Material	Meter body	FC 25 , SUS 316
	Rotors	Resin (PPS)
	Register Housing	Aluminium alloy
Display	Totalizing Counter	8-digit LCD
	Reset Counter	5-digit LCD
Power	Lithium battery	Ratings : 3.6V Life : Approx, 3 or 6 years
Output	Pulse	Max. switching 50V DC, 50mA DC(Reed Switch)

FLOW RANGE

Unit: mm

Model	Size	Flow Range (L/H)	L-A	L-B	L-C	H	W
BH 25	25	50 ~ 3500	198	254	200	260	170
BH 40	40	100 ~ 5000			200	273	170

MODEL CODE

Basic Model	Size	Max. Temp.	Mat'l	Display/output	Connection	Description	
BH	25					1" (25mm)	
						1-1/2" (40mm)	
	40	-0					120 °C
		-1					150 °C
				F			Body / FC 25, Rotor / PPS
				S			Body / SUS316 , Rotor / PPS
					1		5 digit Flowrate/8 digit Totalizer
					2		Totalizer 8 digit/Reset 5 Digit
					3		Pulse output only
					4		5 digit Flowrate/8 digit Totalizer/Pulse
				5		5 digit Flowrate/8 digit Totalizer/4-20 mA	
				+ 6		Explosion Proof- Class I,Division I, Groups B,C&D	
				7			
					BSP	BSP Thread	
					J10	JIS 10K FF	
					J20	JIS 20K FF	
					A15	ANSI 150#FF	
					A30	ANSI 300#FF	

L-B : ANSI Flange
L-C : JIS Flange
L-A : BSP Thread

